

Habitaflex Sanitary Unit

E3 Series

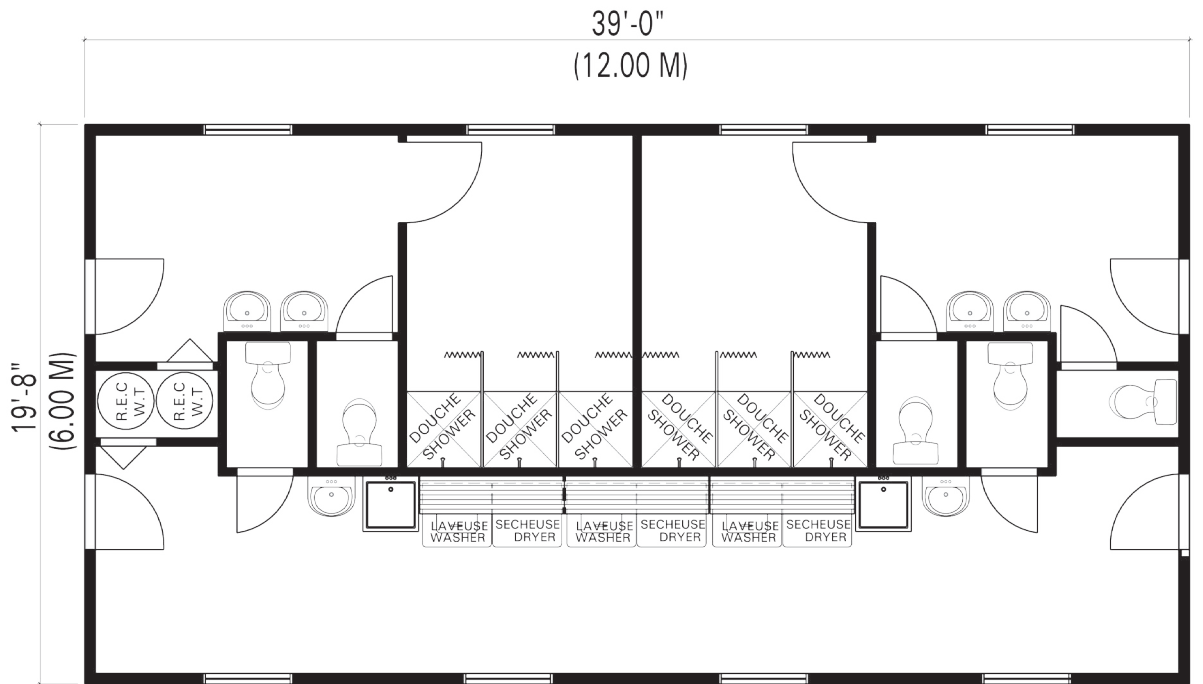

40 S1056

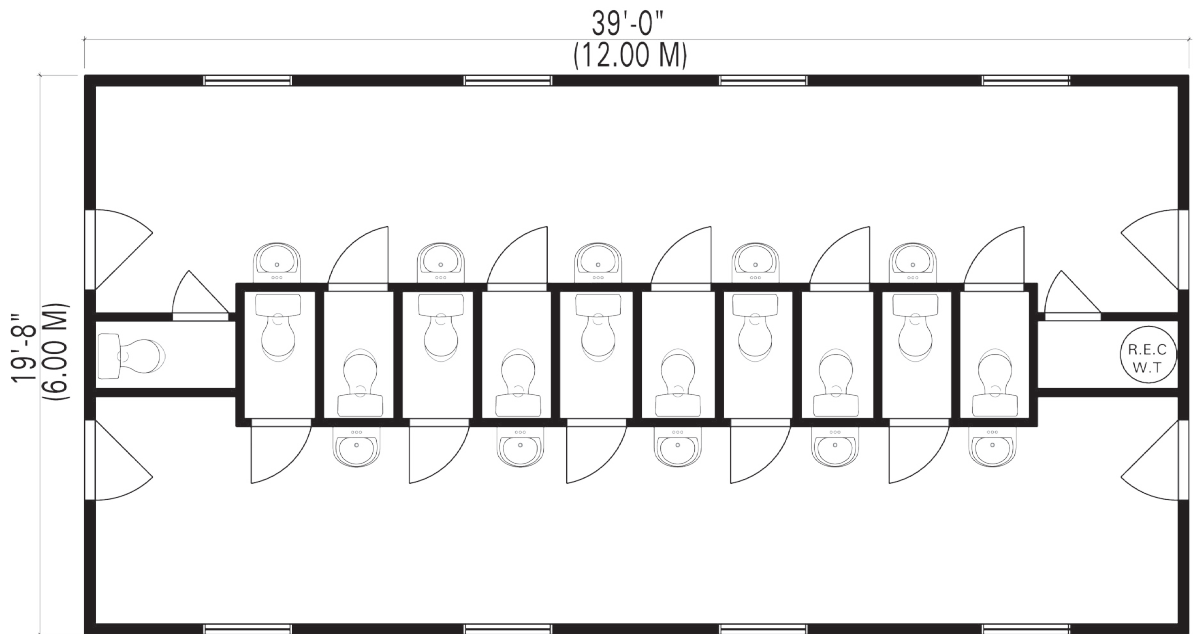

40 S1000



habitaflex.com
HABITAFLEX[®]
 QUICK BUILDING SOLUTIONS



Habitaflex Sanitary Unit

E3 Series

Sanitary (40 S1056, 40 S1000)

Structure:

- Heavy Duty Steel & Timber Frame: Parallel Stand Lumber (PSL), Kiln Dry - Heat Treated lumber (KD HT), Laminated Veneer Lumber (LVL)
- Built with structural insulated panels
- Expanded Polystyrene (EPS) insulation
- Rustic grooved Plywood exterior siding (Choice of colors)
- Pre-painted galvanized steel roofing
- White PVC sliding windows
- Insulated steel door(s)

Interior Finish:

- Rustic grooved Oriented Strand Board (OSB)

Electricity:

- Commercial fluorescent lights
- Powerful Air circulation system
- 2 Hot water tank (60USGL)

Plumbing:

- One-Piece molded fiberglass shower tubs with steel partitions
- Private toilets & Convenient Hand washing stations
- Quick connect water inlet
- 1/2" (12.7 mm) Pex water lines & ABS drainage piping

Options Available:

- Natural Pine board interior finish
- Gypsum board interior finish
- "Far North" Insulation
- Double paned windows
- Borate - treated structural wood (against wood destroying insects & decay fungi)
- "Quick Connect" Electric system
- 220V Electricity
- HRV Air exchanger (Heat & Energy Recovery Ventilator)
- Air conditioning
- Security system (Smoke & Heat detector, manual stations, alarm)